

JAY

1

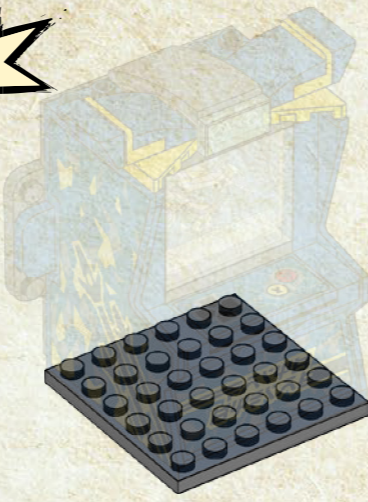

2

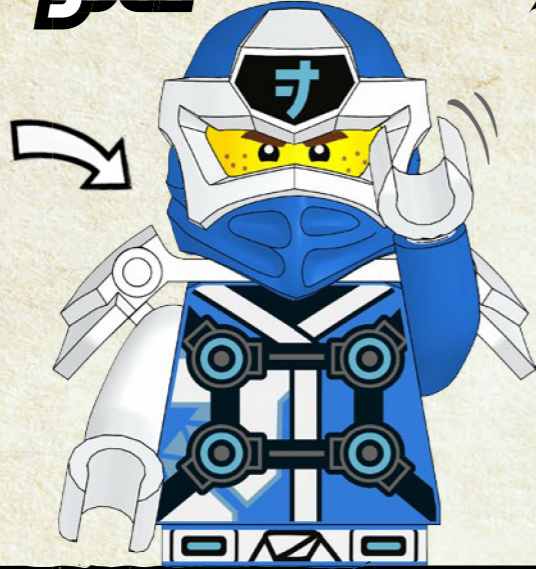
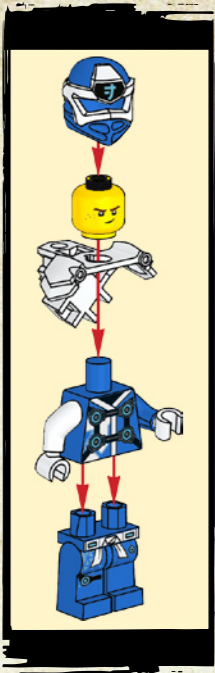
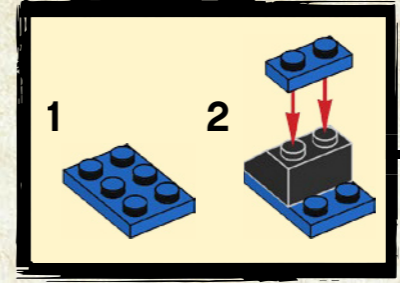
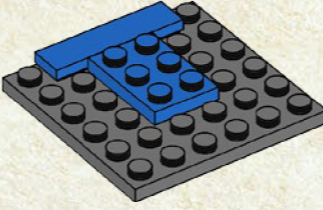

3

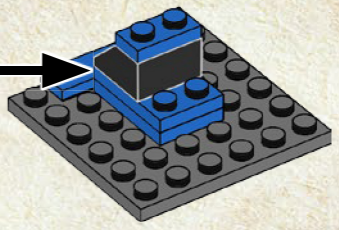

4

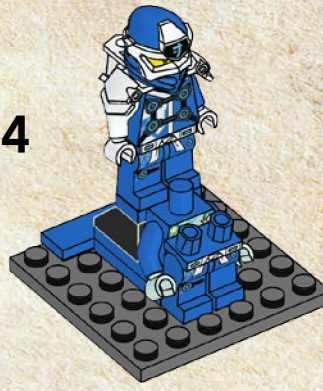

5

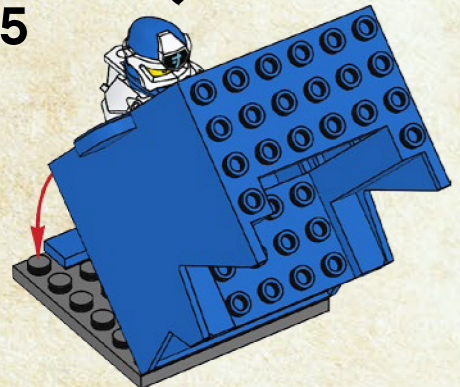

6

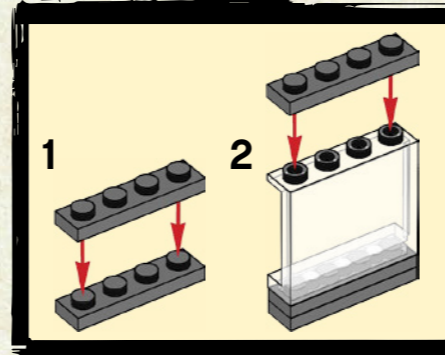
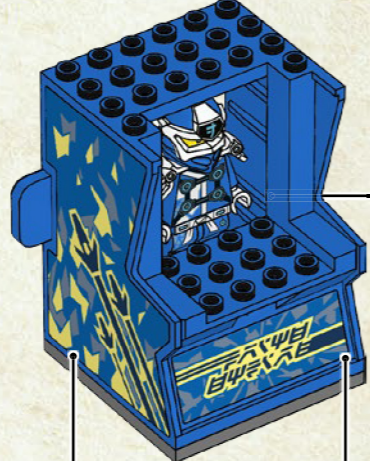

7

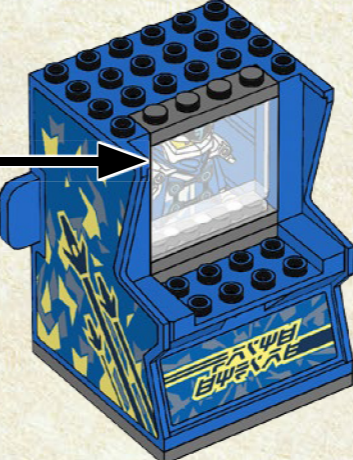

8

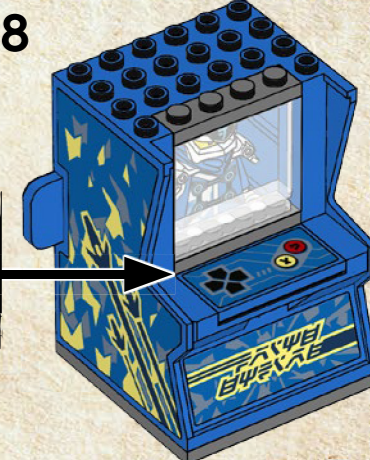
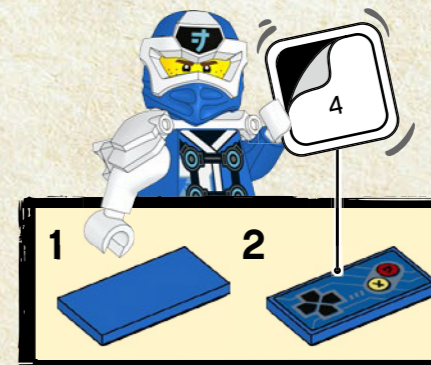

9



10



11

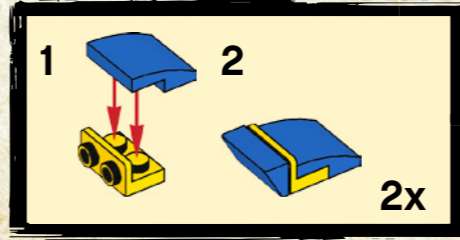

12





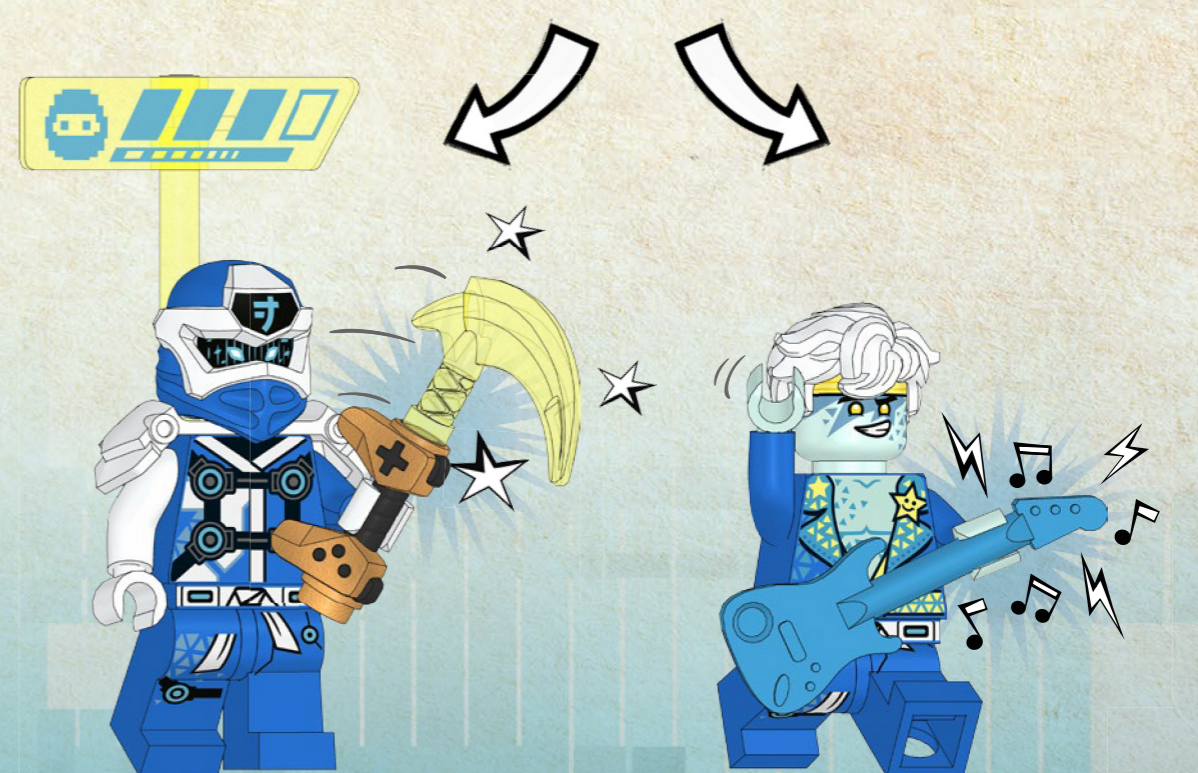
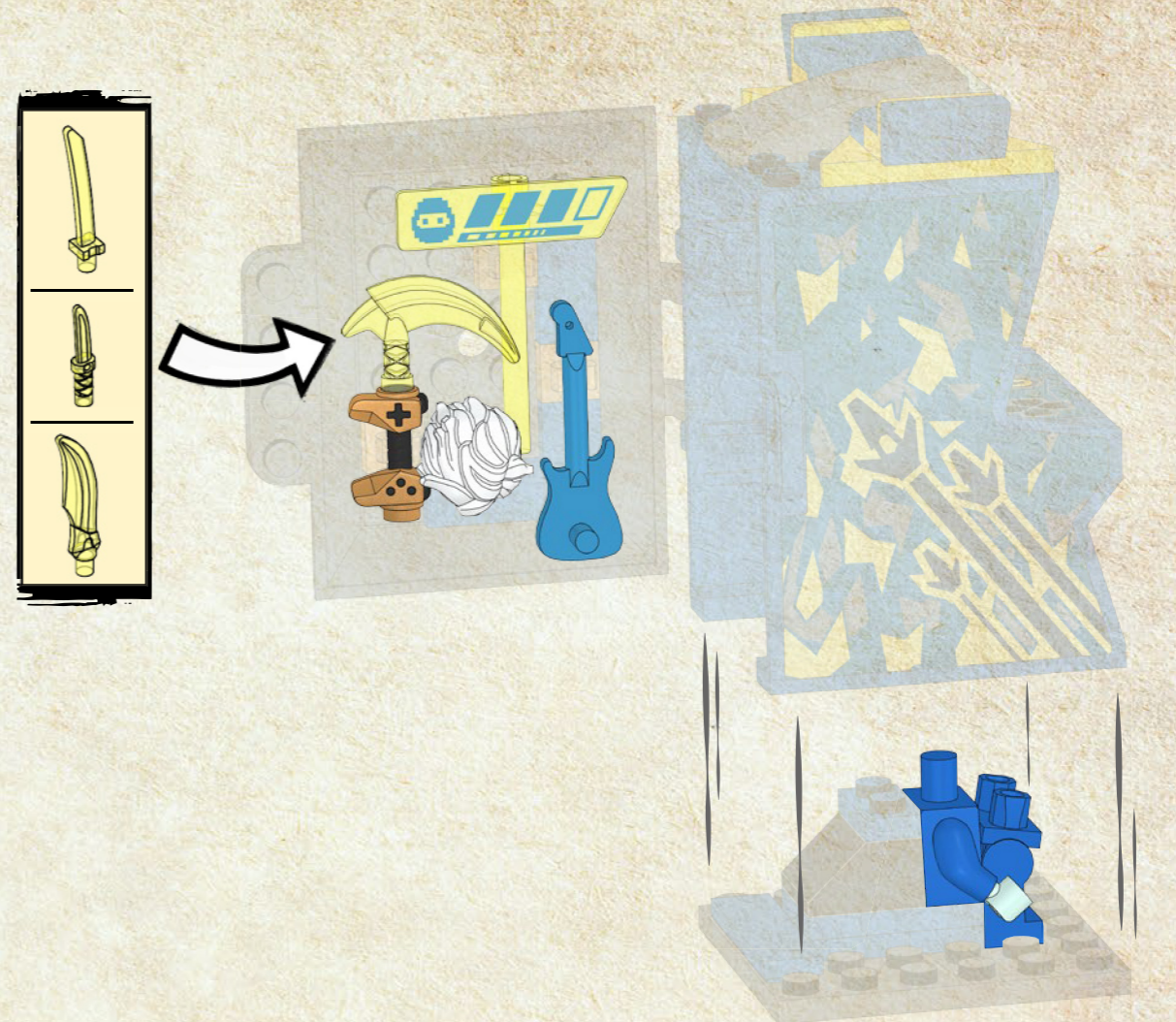
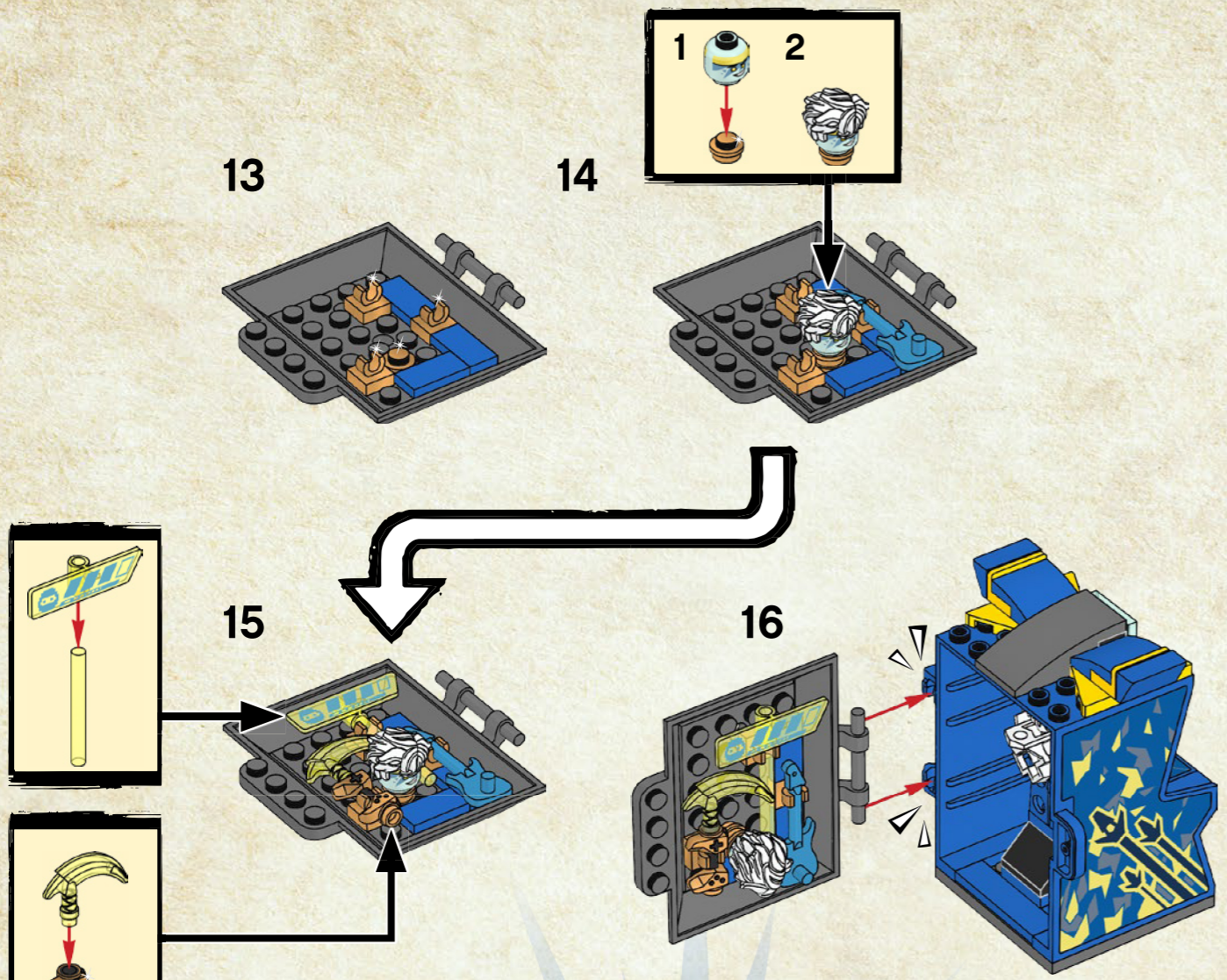

**DIGI JAY**

**AVATAR JAY**

[LEGO.com/NINJAGO](http://LEGO.com/NINJAGO)

[LEGO.com/service](http://LEGO.com/service)

LEGO, the LEGO logo, NINJAGO and the NINJAGO logo are trademarks of the/son des marques de commerce du/son marcas registradas de LEGO Group.  
©2020 The LEGO Group. 6313880/6313881